

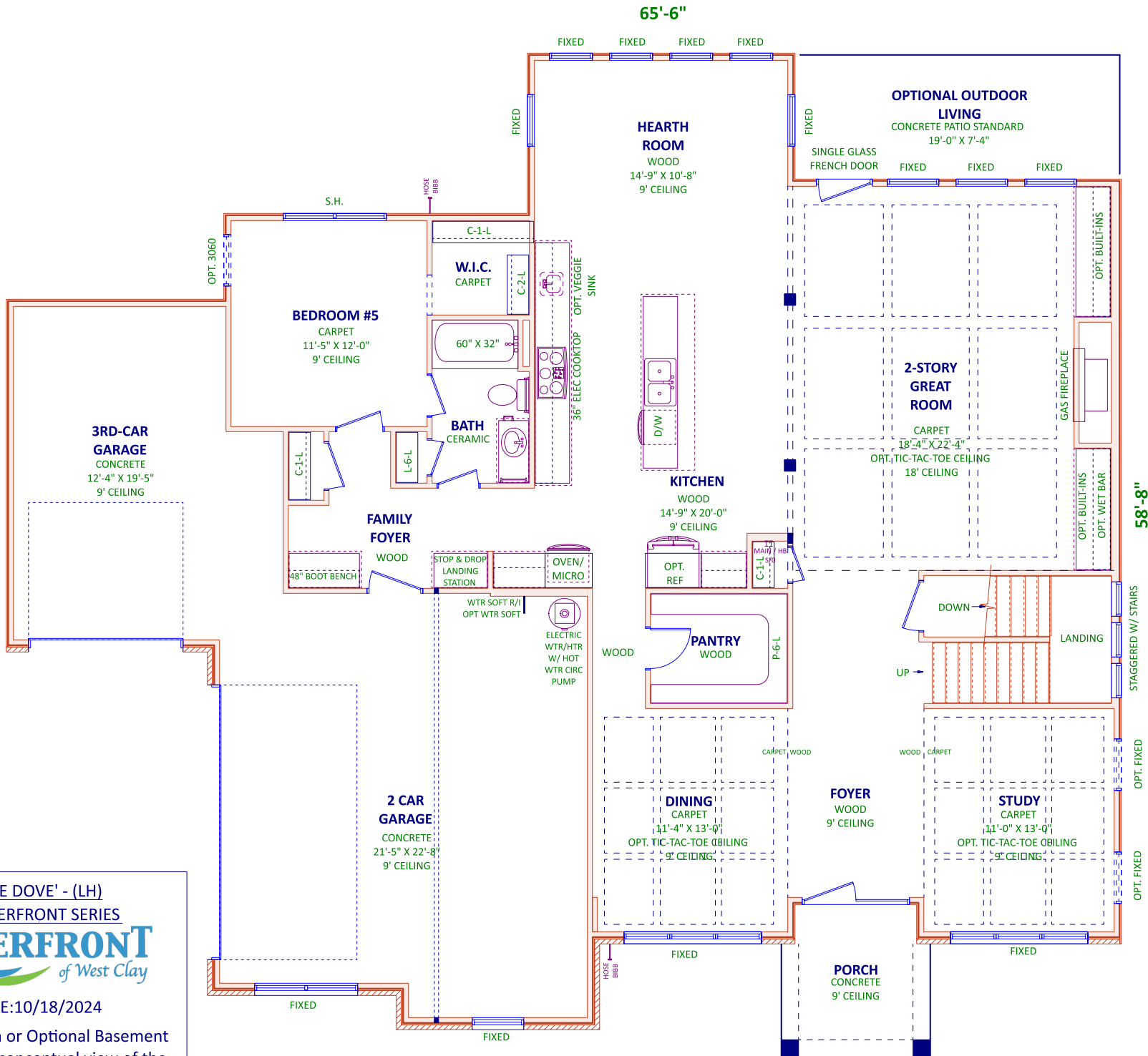

DATE:10/18/2024

The Floor Plan or Optional Basement Brochure is a conceptual view of the home. Prices, plans and specifications are subject to change without notice

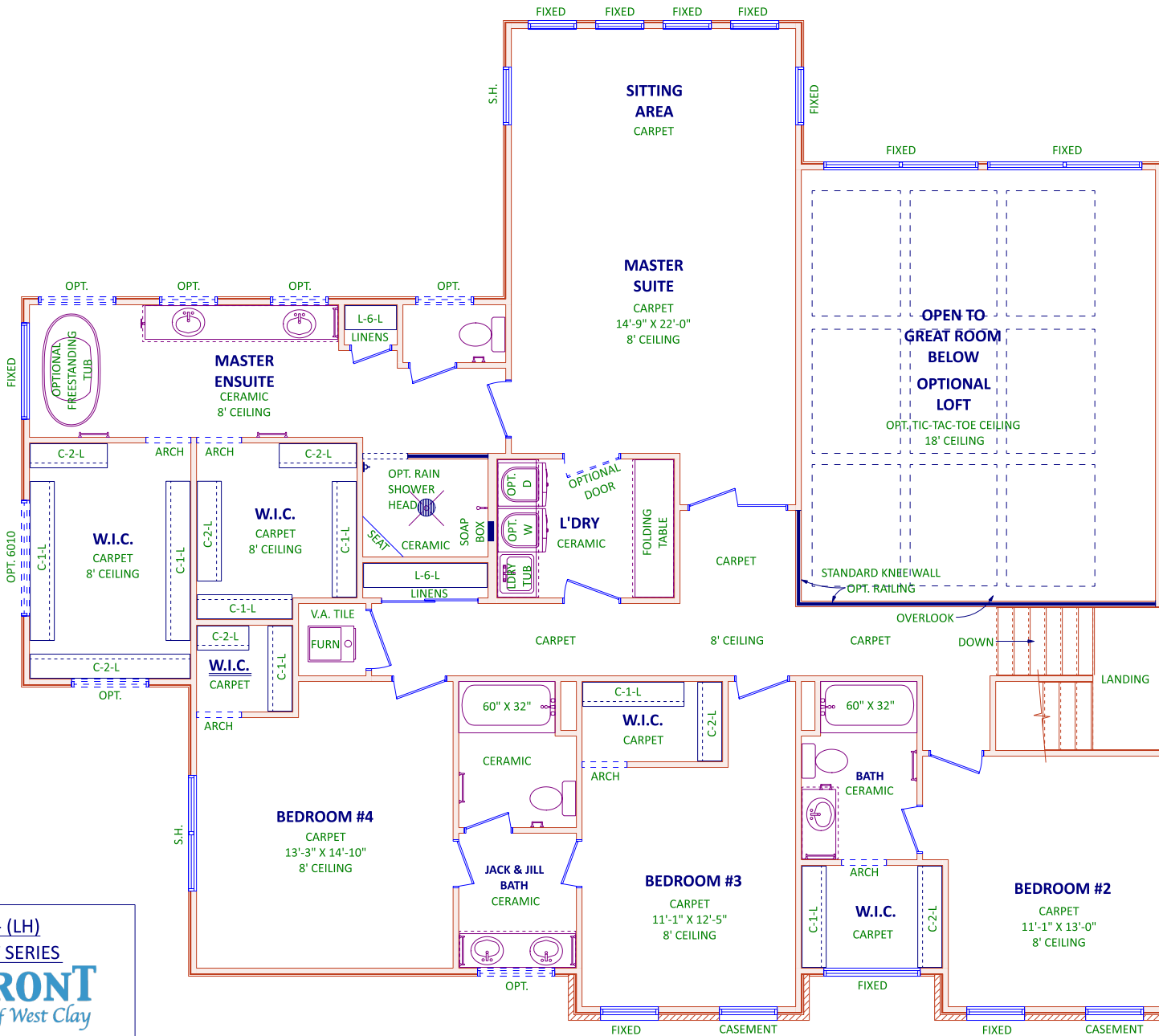



'THE DOVE' - (LH)
WATERFRONT SERIES
Waterfront
of West Clay

DATE:10/18/2024

The Floor Plan or Optional Basement Brochure is a conceptual view of the home. Prices, plans and specifications are subject to change without notice

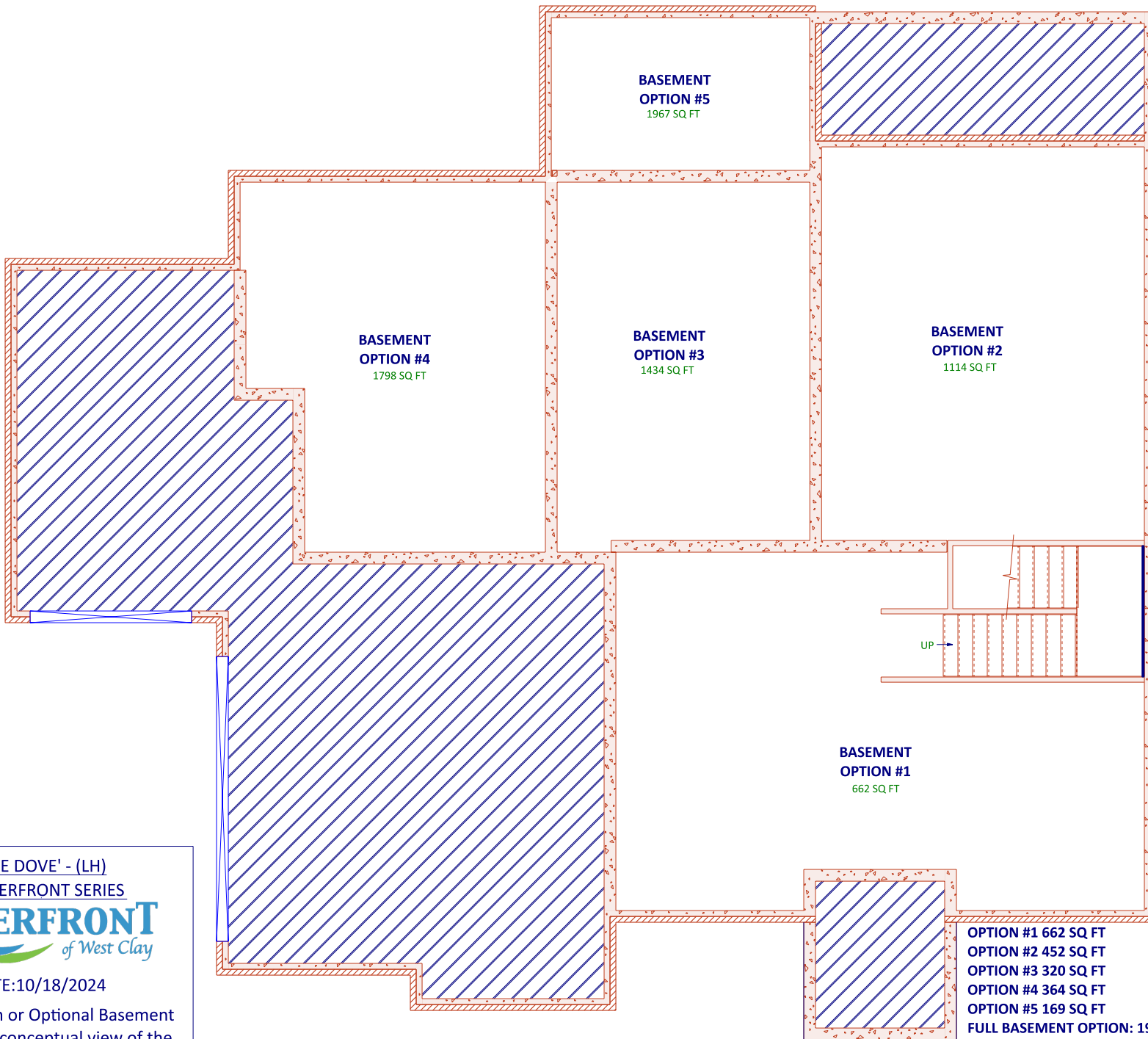

**BASEMENT
OPTION #5**
1967 SQ. FT

**BASEMENT
OPTION #4**
1798 SQ. FT

**BASEMENT
OPTION #3**
1434 SQ. FT

**BASEMENT
OPTION #2**
1114 SQ. FT

**BASEMENT
OPTION #1**
662 SQ. FT

UP →

- OPTION #1 662 SQ. FT
- OPTION #2 452 SQ. FT
- OPTION #3 320 SQ. FT
- OPTION #4 364 SQ. FT
- OPTION #5 169 SQ. FT
- FULL BASEMENT OPTION: 1967 SQ. FT**

'THE DOVE' - (LH)
WATERFRONT SERIES
WATERFRONT
of West Clay

DATE:10/18/2024

The Floor Plan or Optional Basement Brochure is a conceptual view of the home. Prices, plans and specifications are subject to change without notice