

'THE FALCON' - (LH)

WATERFRONT SERIES

Waterfront
of West Clay

DATE: 9/26/2022

The Floor Plan or Optional Basement Brochure is a conceptual view of the home. Prices, plans and specifications are subject to change without notice.

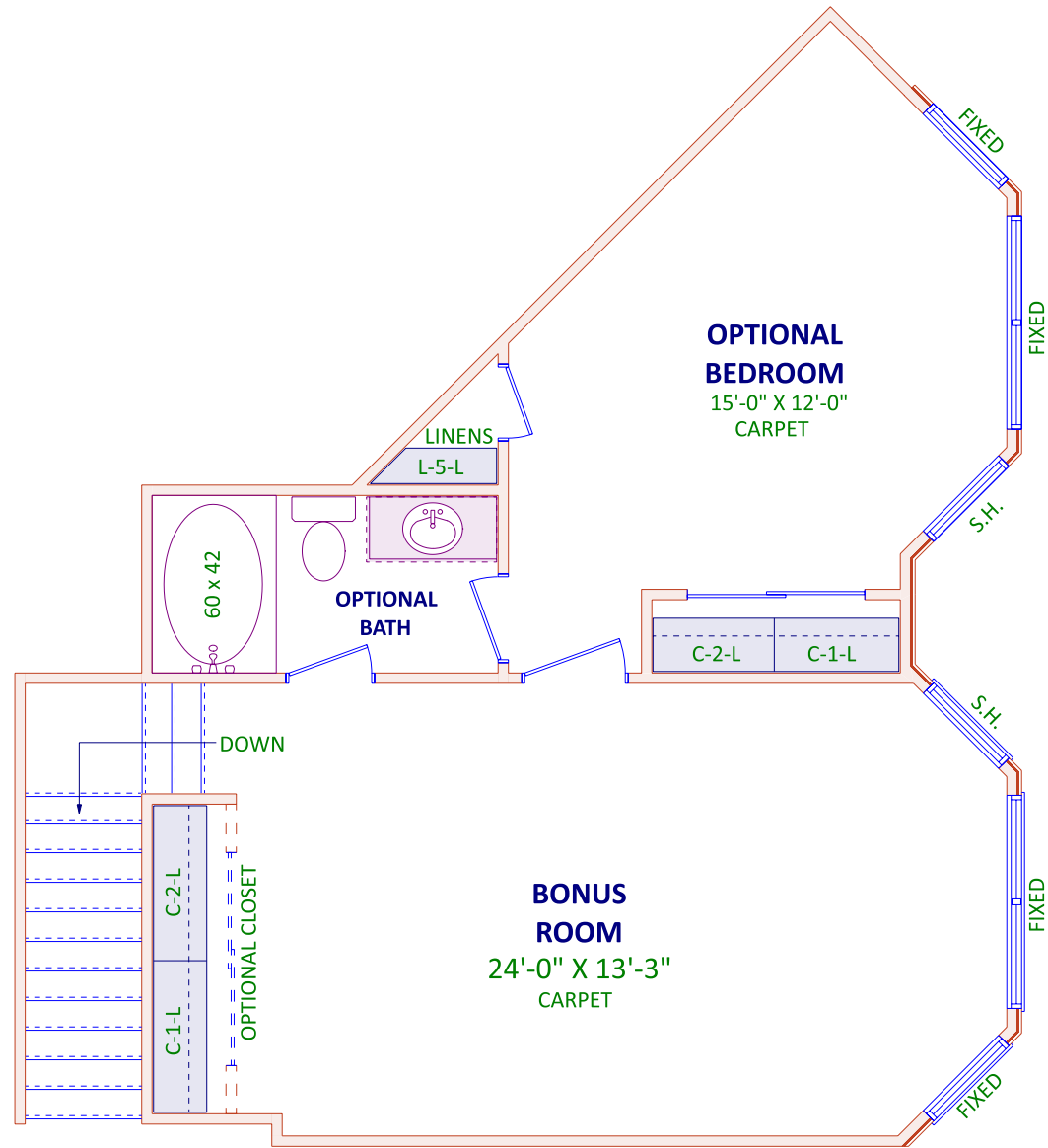

'THE FALCON' - (LH)

WATERFRONT SERIES



DATE: 9/26/2022

The Floor Plan or Optional Basement Brochure is a conceptual view of the home. Prices, plans and specifications are subject to change without notice.

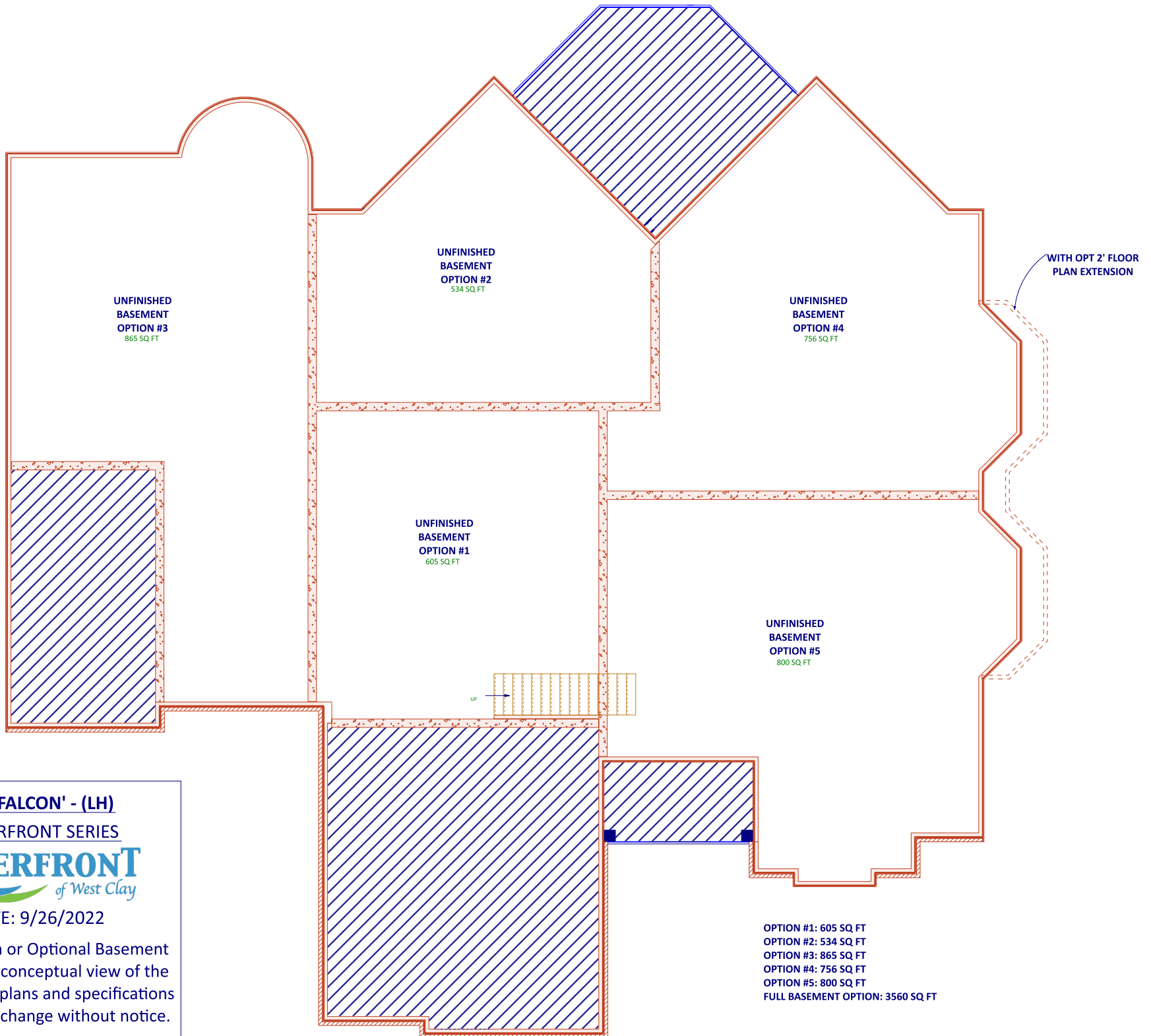

'THE FALCON' - (LH)

WATERFRONT SERIES



DATE: 9/26/2022

The Floor Plan or Optional Basement Brochure is a conceptual view of the home. Prices, plans and specifications are subject to change without notice.

- OPTION #1: 605 SQ FT
- OPTION #2: 534 SQ FT
- OPTION #3: 865 SQ FT
- OPTION #4: 756 SQ FT
- OPTION #5: 800 SQ FT
- FULL BASEMENT OPTION: 3560 SQ FT