

'THE EAGLE' - (LH)
 WATERFRONT SERIES
Waterfront
 of West Clay

DATE:9/26/2022

The Floor Plan or Optional Basement Brochure is a conceptual view of the home. Prices, plans and specifications are subject to change without notice

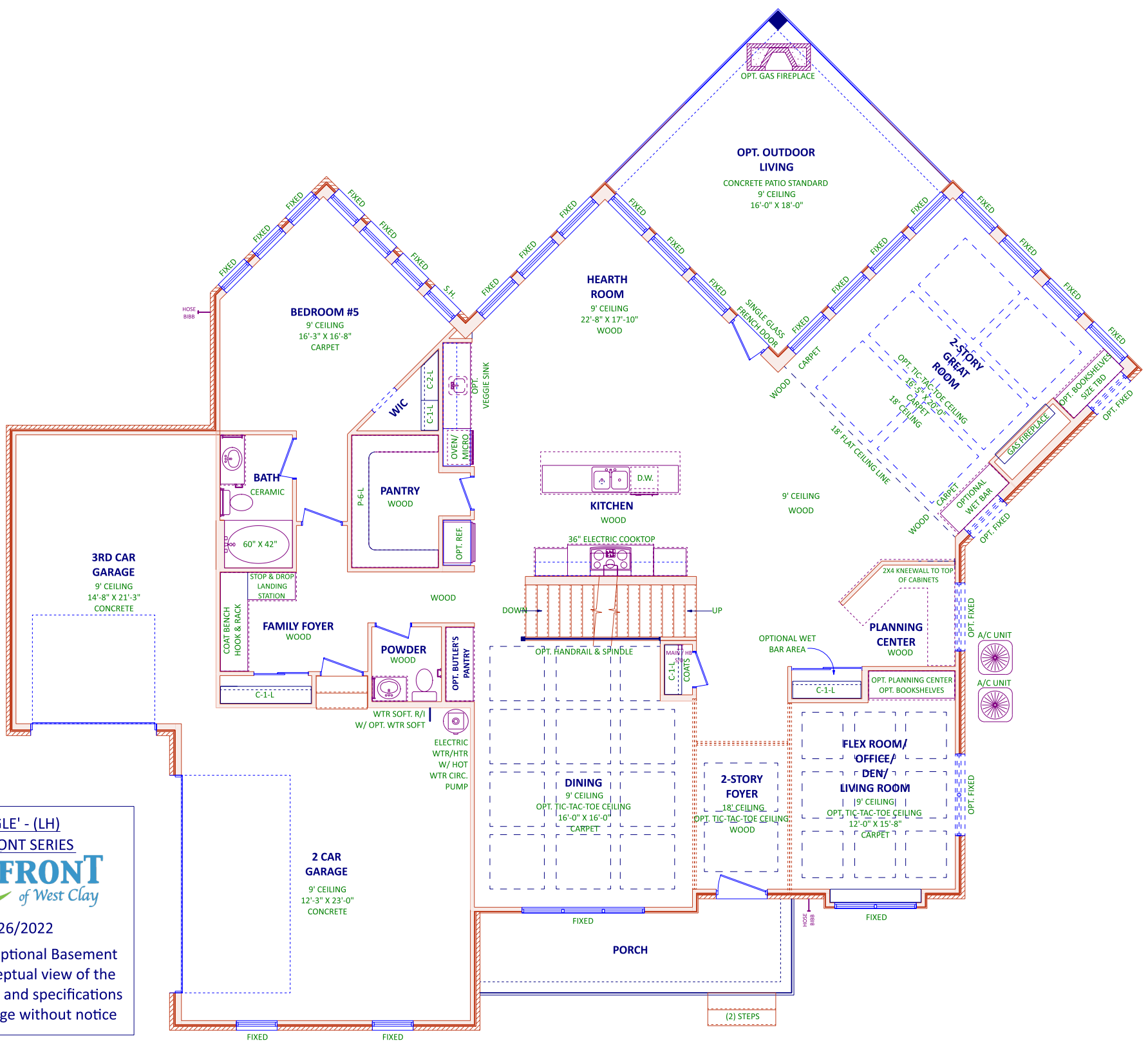

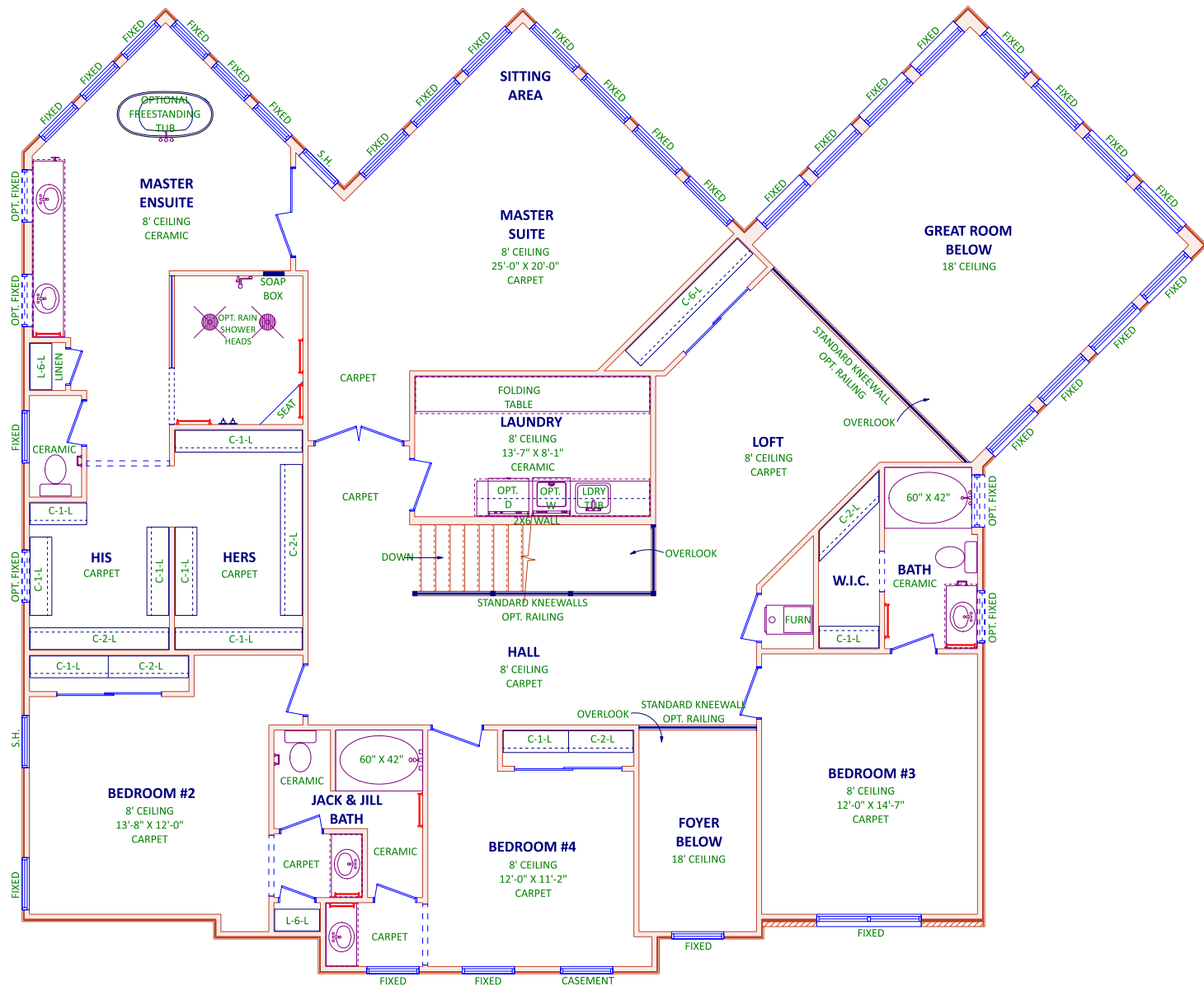

'THE EAGLE' - (LH)
 WATERFRONT SERIES
Waterfront
 of West Clay

DATE:9/26/2022

The Floor Plan or Optional Basement Brochure is a conceptual view of the home. Prices, plans and specifications are subject to change without notice

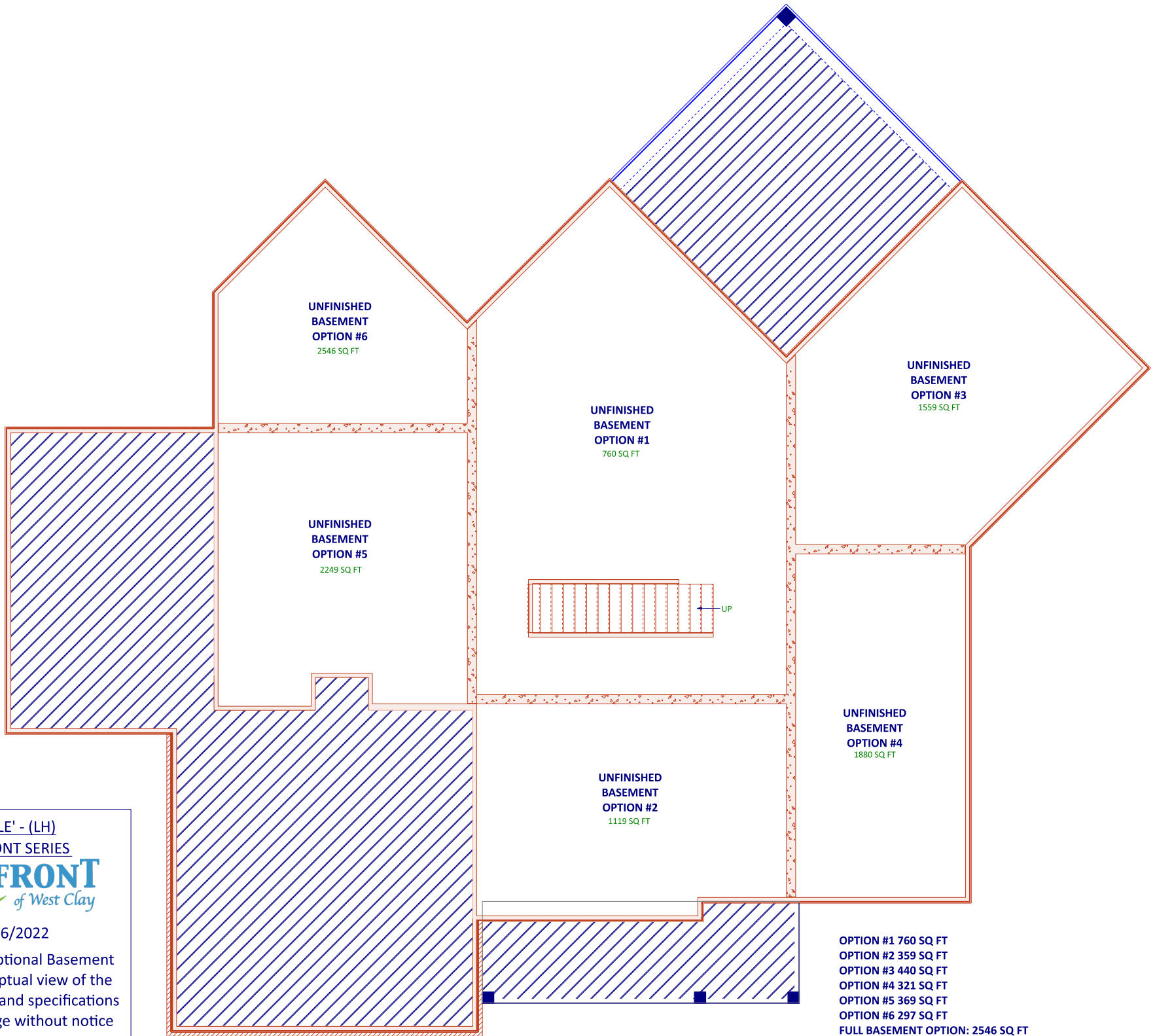

UNFINISHED
BASEMENT
OPTION #6
2546 SQ FT

UNFINISHED
BASEMENT
OPTION #3
1559 SQ FT

UNFINISHED
BASEMENT
OPTION #1
760 SQ FT

UNFINISHED
BASEMENT
OPTION #5
2249 SQ FT

UP

UNFINISHED
BASEMENT
OPTION #4
1880 SQ FT

UNFINISHED
BASEMENT
OPTION #2
1119 SQ FT

OPTION #1 760 SQ FT
OPTION #2 359 SQ FT
OPTION #3 440 SQ FT
OPTION #4 321 SQ FT
OPTION #5 369 SQ FT
OPTION #6 297 SQ FT
FULL BASEMENT OPTION: 2546 SQ FT

'THE EAGLE' - (LH)
WATERFRONT SERIES
WATERFRONT
of West Clay

DATE:9/26/2022

The Floor Plan or Optional Basement Brochure is a conceptual view of the home. Prices, plans and specifications are subject to change without notice